

PROFESSIONAL SM 712CE - 156552; SMA 712CE - 156552

POS. No.	Ref.No.	Description	POS. No.	Ref.No.	Description
1	330483	Circlip B12	70	361271	Screw M 6x16 ISO7380
2	154845	Spindle	71	179609	Spacer washer
3	154846	Spindle gear	72	179610	Washer
4	154856	Spindle set	73	361267	Special nut M6
5	154854	Gear box set	74	179614	Bush
6	933756	Bearing HK0709	75	156551	Pipe L185
7	330119	Bearing HK0609	76	361274	Screw M6X4 DIN 913
8	154844	Bearing shield	77	179630	OUTER PROTECTIVE PIPE SET
9	154862	Armature set	78	155246	Space bush
10	130784	Bush	79	361320	Screw M 8x20 FABORY 07141080025 M Zn A3A
11	330269	Bearing 629-2Z P63 LDS 18	80	361291	Screw C1-M4x30
12	152579	Fan	81	361294	Screw C1-M4x35
13	330582	Bearing 6262ZP6E LDS18 SKF	82	155255	Adaptor
14	129087	Elastic sleeve	83	155293	Hose L400
15	152756	Diffuser	84	179674	Lever set
16	272960	Claming pin	85	179658	Adaptor
17	120831	Stator set	86	330330	O-ring 31X2B
18	131214	Pressure spring 0,5x4x25	87	361276	Screw M6X5 DIN 913
19	152758	Guiding switch lever	90	361136	Pin Ø3x8 DIN7343
20	170117	Slide	91	179644	Lock button
21	151196	Choke	92	115165	Spring
22	129092	Brush	93	179642	Bearing Bushing
23	129093	Brush with a switch	94	155287	Console
24	129082	Brush holder set	95	179625	Space bush
25	153548	Switch APB-2114 Defond	96	361265	Screw M6X42 DIN 427
26	179299	Electronic block	97	179652	Enclosure
27	169564	Cord with a plug	98	330483	Circlip B12
28	256500	Cord clamp	99	331319	Washer AS1528
29	360646	Screw 4x9.5	100	331318	Bearing AXK 1528
30	152759	Cord protector	101	331319	Washer AS1528
31	360654	Screw 4x18	102	179641	Space bush
32	152770	Body with cover	103	330820	Bearing 2RSR
33	361115	Screw K4x50	104	330608	Gasket AS15x28x7 NBR
34	115865	Pin	105	330588	Circlip A28
35	154851	Gasket	106	155258	Spindle
36	154852	Plate	107	179628	Spring
37	154847	Gear shaft	108	155285	Protective cover Ø220
38	154848	Large intermediate gear	109	330486	Circlip B35
39	154849	Gear shaft complement	110	155294	Brush
40	154850	Washer	111	155295	Gasket
41	154855	Bearing shield set	112	155296	Collar
42	330641	Gasket 12x16x3	113	156570	Bush
50	155254	Console	114	121838	Locking nut
51	361280	Screw M 4x6	115	121838	Locking nut
52	361277	Washer 1-M4	117	361319	Screw M 8x20 FABORY 07141080020 M Zn A3A
53	179620	Adaptor	118	184121	Dust Extraction Adaptor
54	361273	Screw M6X6 DIN 913	119	155985	Holder
55	151272	Strip	120	155983	Holder
58	155219	Shaft L650	121	179667	Bush
59	155222	INNER PROTECTIVE PIPE SET L 260	122	361323	Screw M 6x8 ISO7380
60	361288	Screw M 6x30 ISO7380	123	361272	Screw M 6x10 ISO7380
61	179649	Washer	125	155989	Disk
62	361288	Screw M 6x30 ISO7380	125	155259	Disk
63	179613	Stoppole	126	179741	Disk
64	179611	Pipe	126	155297	Disk
65	179614	Bush	127	155991	Disks set 200mm
66	179645	Bush	127	155992	Disks set 225mm
67	179647	Handle set	201	155996	Operating instruction
68	361269	Screw M 6x60 ISO7380	202	156560	Packaging
69	156569	Support			

[1]
[2]
[1]
[1]
[2]
[1]
[2]

Note:
[1] - only for SM 712CE; [2] - only for SMA 712CE

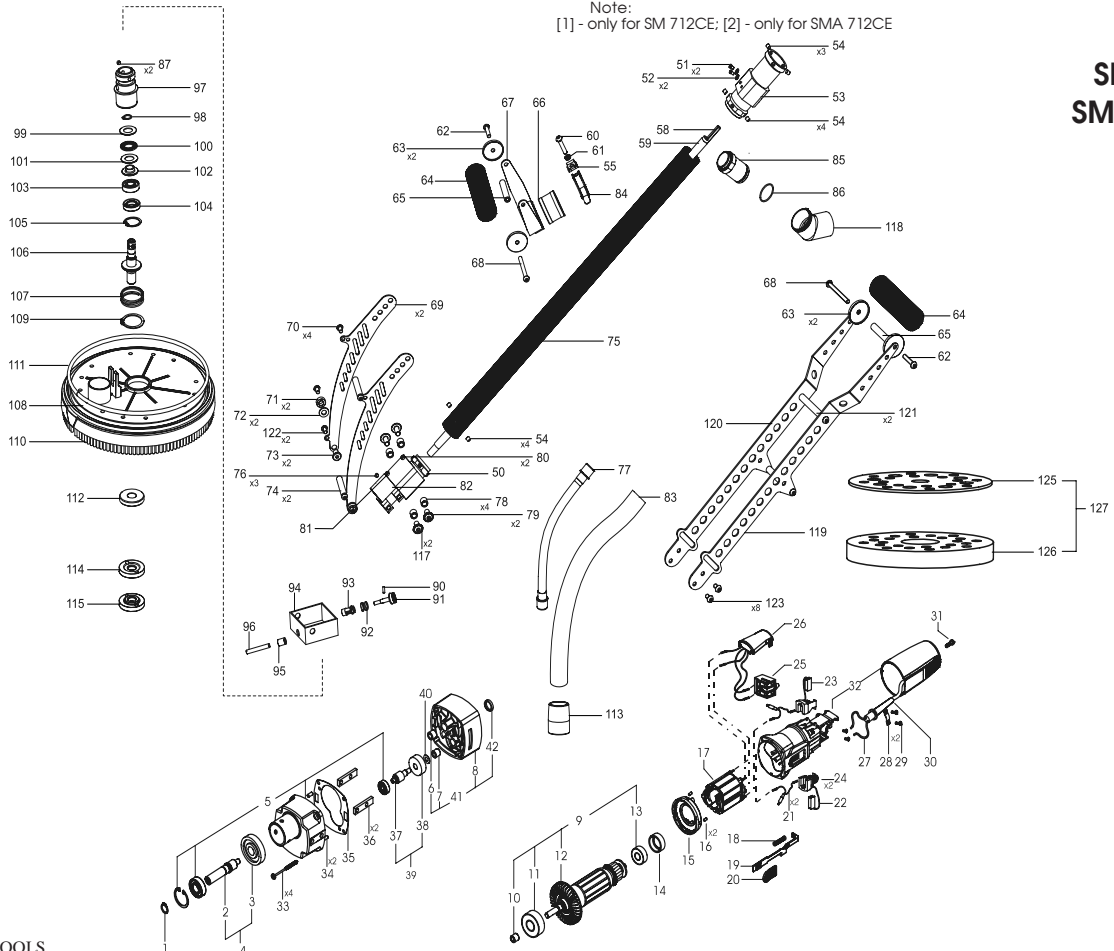

**SM 712CE
SMA 712CE**